

REVISION HISTORY				
ECN	REV	DESCRIPTION	DATE	BY/APPR
10428	A	INITIAL RELEASE	2/10/2011	SMB\
10659	B	Moved 720778041 & 720779040 to drawing 720778041	8/15/2011	RCC\

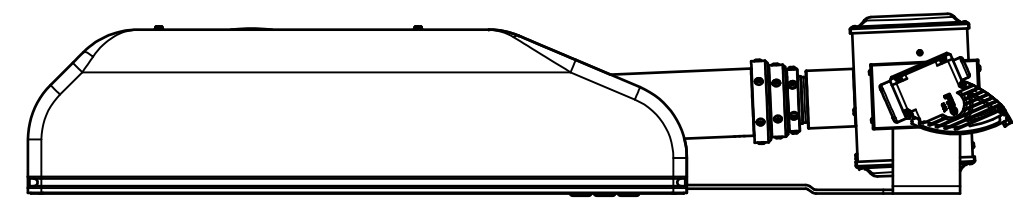
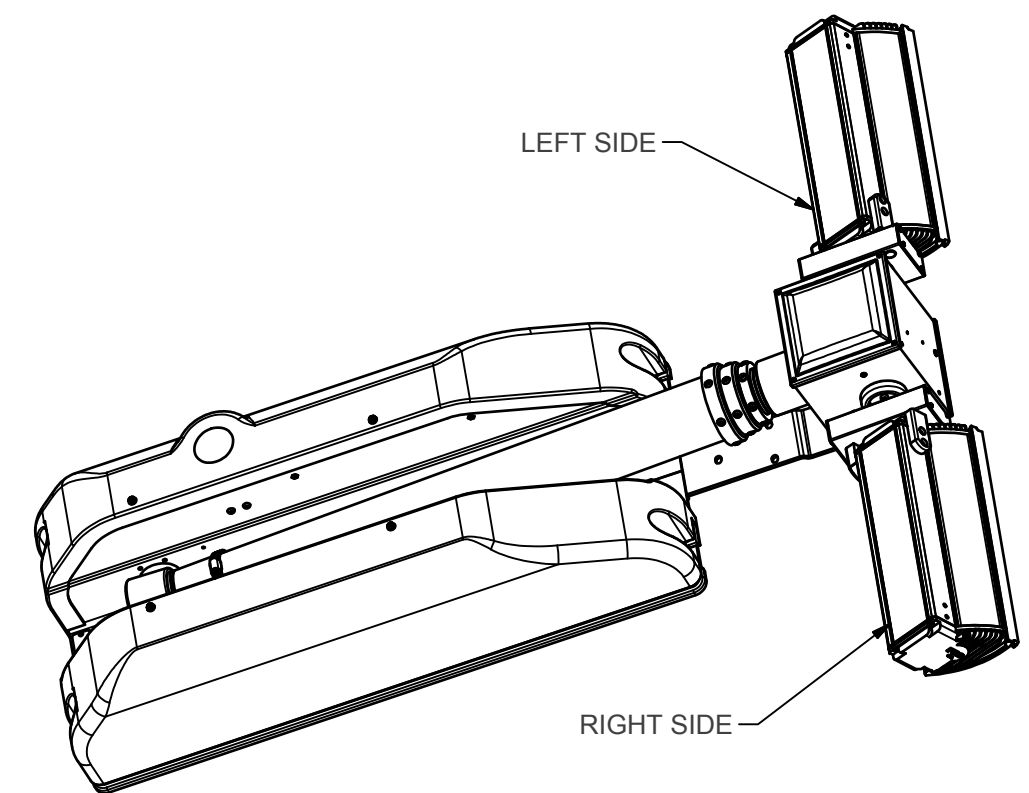
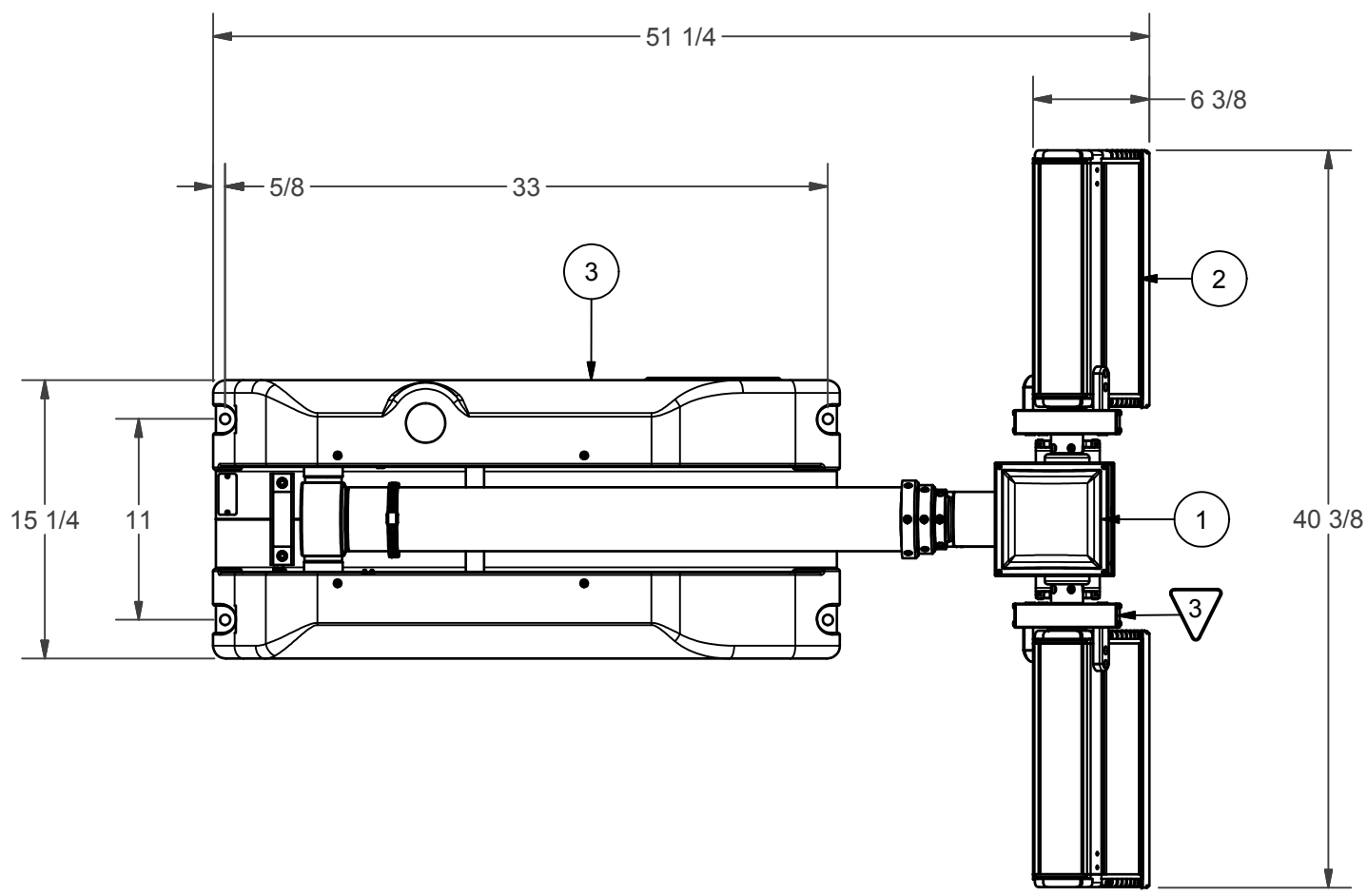

- NOTES:
- 1 APPLY RTV #739 OR EQUAL TO ALL OPEN HOLES.
 - 2 SEE WIRING DIAGRAM 46066 FOR ALL UNITS.
 - 3 SET LIGHT BARS HOME POSITION PARALLEL TO BASE PLATE WHEN STOWED.

APPROX. WT: 93.06 lbmass

THIRD ANGLE PROJECTION



UNLESS OTHERWISE SPECIFIED DIMENSIONS ARE IN INCHES.

TOLERANCES ON DECIMALS ANGLES
0 = ± 0.030 ± 1/2°
00 = ± 0.010
000 = ± 0.005

FRACTIONAL ± 1/64"

1. ALL INSIDE EDGES TO HAVE .005" TO .035" FILLETS.
2. ALL OUTSIDE EDGES TO HAVE .005" TO .015" CHAMFER OR RADIUS.

125° ON ALL MACHINED SURFACES

PROPRIETARY AND CONFIDENTIAL

THE INFORMATION CONTAINED IN THIS DRAWING IS THE SOLE PROPERTY OF THE WILL-BURT COMPANY ANY REPRODUCTION IN PART OR WHOLE WITHOUT THE WRITTEN PERMISSION OF THE WILL-BURT COMPANY IS PROHIBITED.

WILL-BURT AN EMPLOYEE OWNED COMPANY
ORRVILLE, OH

TITLE
NS 2.3 2-LIGHT LONG OPTIMUM KIT (AC & DC)

APPROVALS	DATE
DRAWN SMB	2/10/2011
CHECKED	

SIZE	DWG NO	REV
B	720748041	B

PN: SEE TABLE SHEET 1 OF 2

4

3

2

1

Table

ASSEMBLY NO	ITEM 2 PART NO	ITEM 2 DESCRIPTION
720748041	4573501	OPT 2 LIGHT, 3000W (2-1500W 220VAC) WHT
720770042	4573513	OPT 2 LIGHT, 1800W (2-900W 220VAC) WHT



B

B

A

A

BOM			
ITEM	QTY	PART NUMBER	DESCRIPTION
1	1	4548301	NSC RCP, LIGHTS ONLY
2	1	SEE TABLE	LIGHT KIT
3	1	4522001	BASE ASSEMBLY, 7.5 CLR
4	1	4558901	NSC LABEL KIT (NOT SHOWN)
5	1	900600	MAST OIL (SHIP LOOSE)
6	1	TP-4602001	MANUAL, NS 1.8/2.3, CE, CD VERSION (NOT SHOWN)

UNLESS OTHERWISE SPECIFIED
DIMENSIONS ARE IN INCHES.

TOLERANCES ON DECIMALS ANGLES
 0 = ± 0.030 ± 1/2°
 00 = ± 0.010
 000 = ± 0.005

FRACTIONAL ± 1/64"

1. ALL INSIDE EDGES TO HAVE
.005" TO .035" FILLETS.
 2. ALL OUTSIDE EDGES TO HAVE
.005" TO .015" CHAMFER OR RADIUS.

125° ON ALL MACHINED SURFACES

APPROX. WT: 93.06 lbmass

THIRD ANGLE PROJECTION



PROPRIETARY AND CONFIDENTIAL
 THE INFORMATION CONTAINED IN THIS
 DRAWING IS THE SOLE PROPERTY OF THE
 WILL-BURT COMPANY ANY REPRODUCTION
 IN PART OR WHOLE WITHOUT THE WRITTEN
 PERMISSION OF THE WILL-BURT COMPANY IS
 PROHIBITED.



TITLE
**NS 2.3 2-LIGHT LONG
 OPTIMUM KIT (AC & DC)**

APPROVALS	DATE
DRAWN SMB	2/10/2011
CHECKED	

SIZE	DWG NO	REV
B	720748041	B

PN: SEE TABLE SHEET 2 OF 2

4

3

2

1