

Trailer Skid Elevation System OPTIMUS

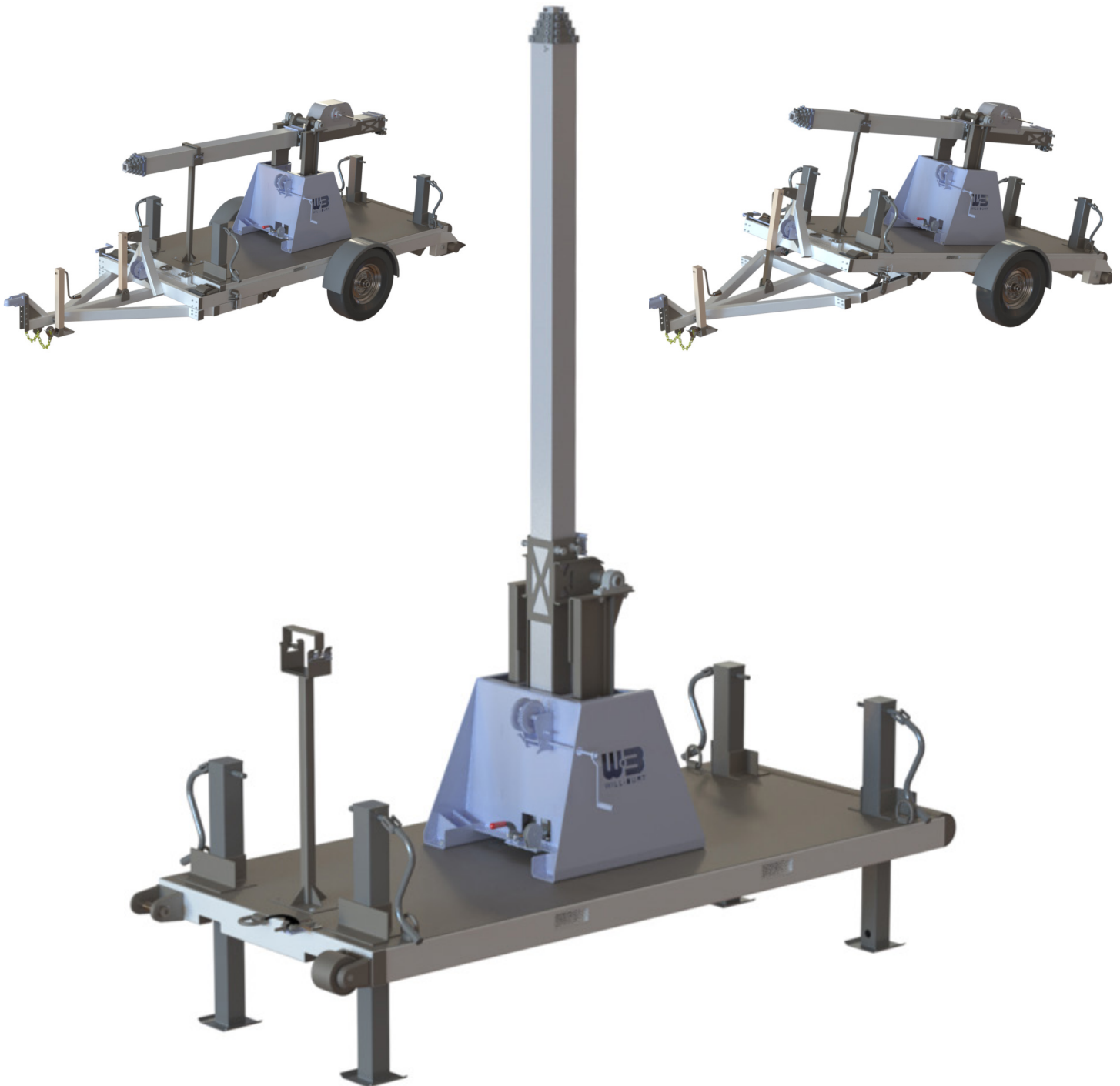

Visit
Corporate
Website



Watch
Corporate
Video

AMERICAS

WB
WILL-BURT

INNOVATION ELEVATED®

Trailer Skid Elevation System OPTIMUS

INTRODUCING THE

OPTIMUS TRAILER SKID ELEVATION SYSTEM

by Will-Burt

Elevate your operations with the **Optimus Trailer Skid Elevation System!** A cost-effective and versatile solution designed to deploy elevated sensors across multiple sites. With the ability to utilize a single Optimus trailer for multiple skids, you benefit from reduced equipment needs and lower maintenance costs, ultimately saving you time and money.

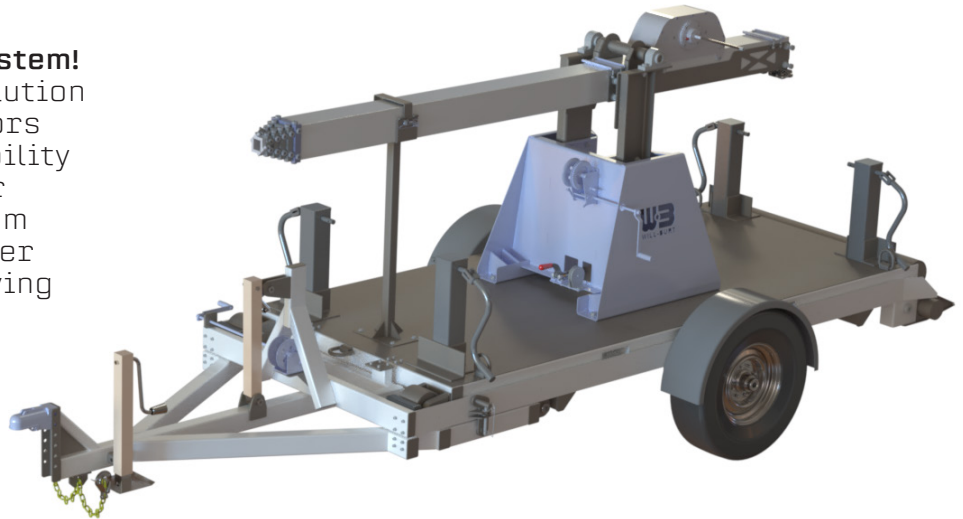

Key Features

- **Power-Free Deployment**
 - The Optimus system requires no power to deploy or retrieve the skid or elevate the sensor, ensuring simplicity and efficiency.
- **Rugged GEROH KVR Telescopic Mast on tilt**
 - Featuring the lightweight yet robust GEROH KVR cable-driven telescopic mast, this system guarantees superior stability, reliability, and longevity. Ideal for telecommunications, sensors, surveillance, and lighting applications. Guy capable and available in 45 ft. / 14 m and 52 ft. / 16 m heights.
- **Precision Engineering**
 - The mast's precision-engineered profiles ensure accurate positioning, while the two strong internal cables, protected from environmental elements, provide positive retraction through ice and dirt.
- **Extreme Temperature Performance**
 - The mast operates seamlessly in temperatures ranging from -25°F [-32°C] to $+111^{\circ}\text{F}$ [$+44^{\circ}\text{C}$], delivering reliable performance even in harsh conditions.

DEPLOY AN OPTIMUS SKID IN 3 EASY STEPS

1 Tow to Location



2 Deploy Skid



3 Elevate Mast

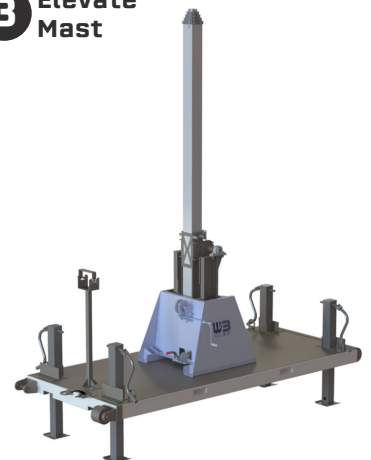

Trailer Skid Elevation System OPTIMUS

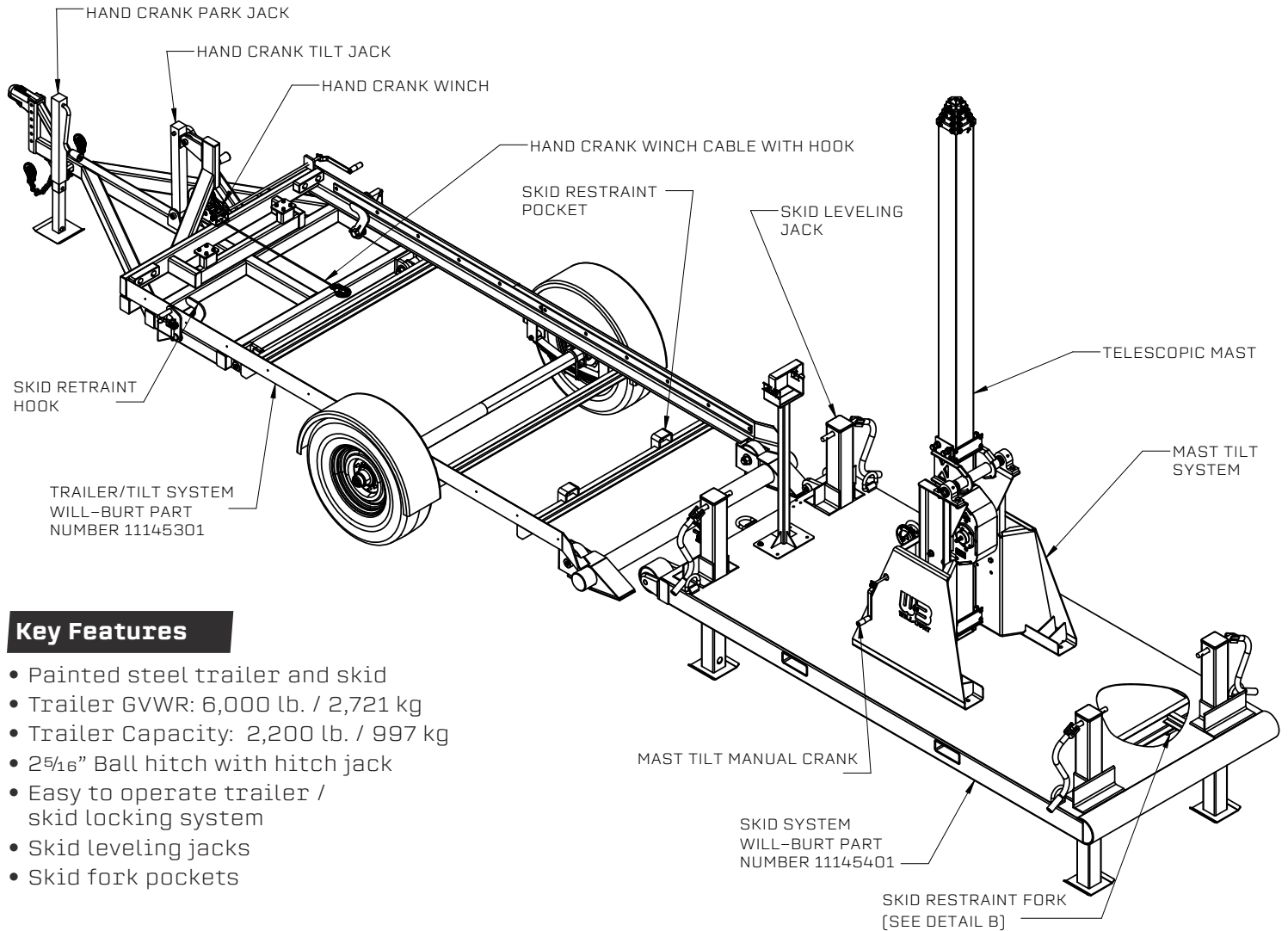

Key Features

- Painted steel trailer and skid
- Trailer GVWR: 6,000 lb. / 2,721 kg
- Trailer Capacity: 2,200 lb. / 997 kg
- 2 $\frac{5}{16}$ " Ball hitch with hitch jack
- Easy to operate trailer / skid locking system
- Skid leveling jacks
- Skid fork pockets

Specifications

GEROH KVR Telescoping Mast with Tilt	170-14 KVR 6	170-16 KVR 6
Extended Height AGL [ft. / m]	48.0 / 14.6	54.5 / 16.6
Stowed Vertical Height AGL [ft. / m]	13.3 / 4.0	14.7 / 4.4
Stowed Horizontal Height AGL [ft. / m]	6.9 / 2.0	6.9 / 2.0
Payload Capacity [lb. / kg]	88 / 40	88 / 40
Number of Sections	6	6

GEROH KVR masts are available with guy systems for extra stability
 Payload sail area may affect payload capacity - contact factory for more information.

Trailer Skid Elevation System OPTIMUS

Dimensions

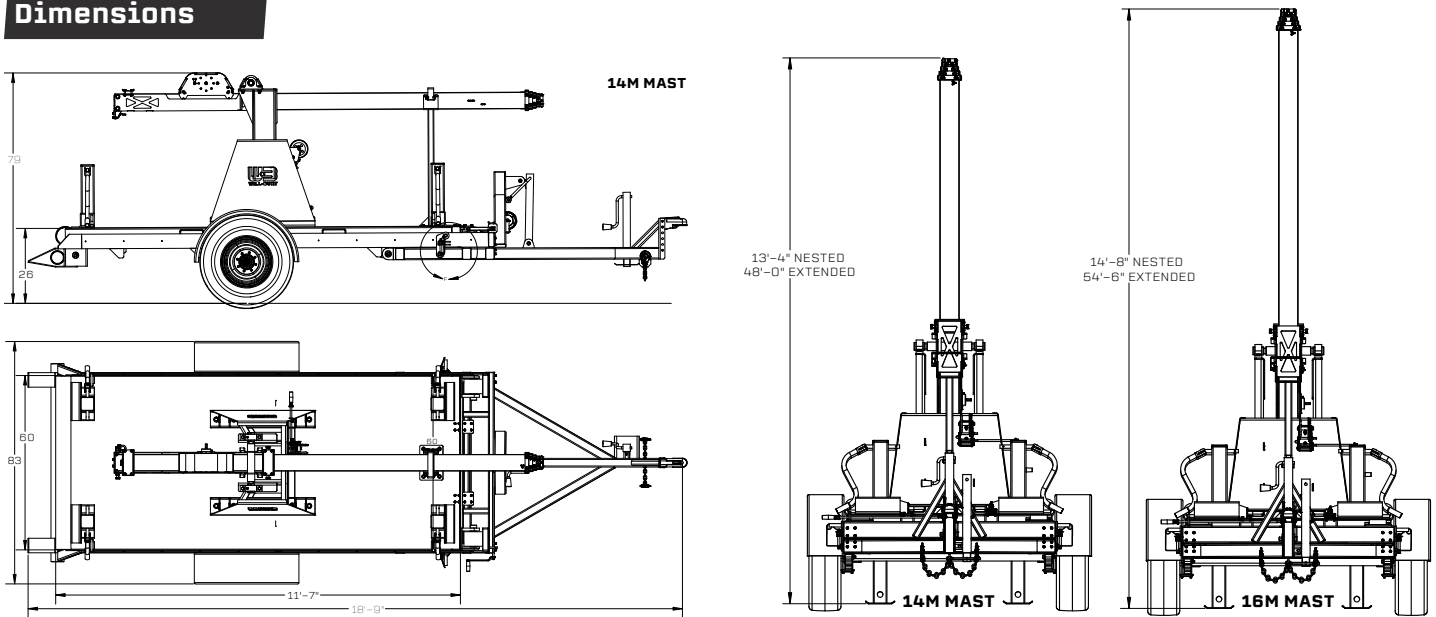

CONTACT YOUR SALES REPRESENTATIVE TODAY

Barry Page

VP of Mast Sales and Programs - Americas

Mobile: 678.595.2832

bpage@willburt.com

Joe Schanda

Sales Manager - North America

Mobile: 330.347.9388

jschanda@willburt.com

WILL-BURT NORTH AMERICA WORLD HEADQUARTERS

401 Collins Boulevard, Orrville, OH USA 44667

Telephone: +1 330 682 7015

Mast Customer Service: +1 330 684 4000

Fax: +1 330 684 1190

Email: info@willburt.com

WILL-BURT UNITED KINGDOM

Unit 5b, Station Approach

Four Marks, Alton Hampshire, GU34 5HN, United Kingdom

Telephone: +44 (0) 1403 265532

Fax: +44 (0) 1403 259072 / Email: info@willburt.com

INTEGRATED TOWER SYSTEMS A WILL-BURT COMPANY

2703 Dawson Road

Tulsa, OK 74110

Telephone: +1 800 850 8535

Fax: +1 918 749 8537

Email: programs@itstowers.com

WILL-BURT ASIA SINGAPORE SALES OFFICE

1 Fullerton Road, #02-01 One Fullerton,

Singapore 049213

Telephone: +65 6832 5689

Fax: +65 6722 0664 / Email: info@willburt.com

ALUMA TOWER A WILL-BURT COMPANY

1639 Old Dixie Highway

Vero Beach, Florida 32960

Telephone: +1 772 567 3423

Fax: +1 772 567 3432

Email: info@alumatawer.com

WILL-BURT GERMANY

Fischergasse 25

D-91344 Waischenfeld, Germany

Telephone: +49 9202 180

Fax: +49 9202 1811

Email: info@willburt.com

CLARK MASTS A WILL-BURT COMPANY

18-20 Ringwood Road, Binstead, Isle of Wight, PO33 3PA, England

Telephone: +44 (0) 1983 563691/567090

Fax: +44 (0) 1983 566643/811157

E-mail: sales@clarkmasts.com

The Will-Burt Company, headquartered in Orrville, Ohio, USA, is the world's premier manufacturer of mobile telescoping masts, towers and pan and tilt positioners. We offer virtually every mobile payload elevation and integration solution for defense, government, first responders, cellular and mobile, broadcast, energy production and other markets. Will-Burt also offers contract manufacturing, metal fabrication, powder-coating, and rapid prototyping services. Will-Burt is an international company with offices and manufacturing in the USA, England, and Germany along with offices in Singapore. All Will-Burt Company manufacturing locations are backed by a certified ISO 9001:2015 Quality Management System. Incorporated in 1918, Will-Burt is 100% employee-owned and is classified as a small business.



Disclaimer: Dimensions and weights are for reference only and are subject to change.
Please contact Will-Burt for current engineering specifications.

© March, 2025

The Will-Burt Company

ISO 9001:2015

INNOVATION ELEVATED®